

# CIM 175/75 - CIM 175 - CIM 300

PRODUTTORI GHIACCIO CUBETTO PIENO - FULL CUBE ICE MAKERS

MACHINES À GLACE GLAÇONS PLEIN - FABRICADORES HIELO EN CUBITOS MACIZOS



175/300 kg/24 h

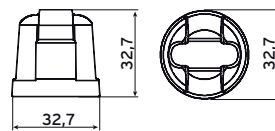

Cubetto / Cube / Glaçons / Cubitos  
18 gr

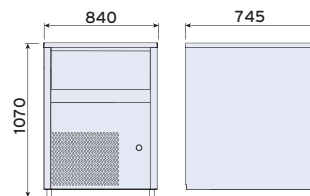

CIM 175/75

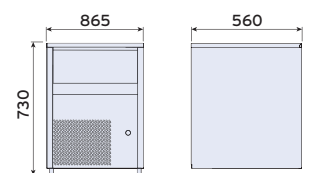

CIM 175

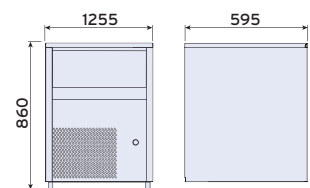

CIM 300



- Costruzione in acciaio inox e materiali idonei al contatto con gli alimenti
- **Vasca raccolta ghiaccio integrata per CIM 175/75**
- Gas R404a
- Condensazione (A) aria o (W) acqua
- Controlli elettronici
- Voltaggi speciali, su richiesta
- Macchine rispondenti alle normative di igiene e di sicurezza in vigore
- **Condizioni di lavoro standard:**  
temperatura acqua 15°C  
temperatura ambiente 20°C



- *Construction in stainless steel and specific materials approved for contact with food stuff*
- **Built-in ice collection tank for CIM 175/75**
- Gas R404a
- (A) Air or W (Water) condensing
- *Electronic controls*
- *Special voltages, on request*
- *Machines comply with hygiene and safety regulations*
- **Standard working conditions:**  
*incoming water temperature 15°C*  
*environment air temperature 20°C*



- Construction en acier inox et matériaux pour aliments
- **Bac de récupération de la glace intégré pour CIM 175/75**
- Gaz R404a
- Condensation (A) air ou (W) eau control électronique
- Tensions spéciales, sur demande
- Machines conformes aux normes en vigueur en matière d'hygiène et de sécurité
- **Conditions de travail standard:**  
temperature eau 15°C  
temperature environnement 20°C



- *Estructura de acero inoxidable y materiales para alimentos*
- **Cuba colectora de hielo integrada en CIM 175/75**
- Gas R404a
- *Comandos electronicos condensacion (A) aire o (W) agua*
- *Voltajes especiales a petición*
- *Máquinas conformes a las normas vigentes en materia de higiene y seguridad*
- **Condiciones de trabajo standards:**  
temperatura entrada agua: 15°C  
temperatura ambiente: 20°C

	CIM 175/75	CIM 175	CIM 300
Produzione - Productivity Production - Producción	175 Kg/24 h 10294 cubetti/cubes/glaçon/cubitos	175 kg/24 h 10294 cubetti/cubes/glaçon cubitos	300 kg/24 h 17650 cubetti/cubes/glaçon/cubitos
Capacità deposito - Storage capacity Capacite bac - Capacidad depósito	75 kg 4411 cubetti/cubes/glaçon/cubitos approx	-	-
Potenza elettrica - Electrical Power Puissance électrique - Potencia eléctrica	1,7 kW	1,7 kW	2,7 kW
Peso netto - Net weight - Poids net - Peso neto	113 kg	97 kg	153 kg

ACCESSORI - ACCESSORIES - ACCESSOIRES - ACCESORIOS (pag. 27-30)

