

# CIM 20/5 - CIM 30/10 - CIM 45/15

PRODUTTORI GHIACCIO CUBETTO PIENO - FULL CUBE ICE MAKERS

MACHINES À GLACE GLAÇONS PLEIN - FABRICADORES HIELO EN CUBITOS MACIZOS



20-30-45 kg/24 h

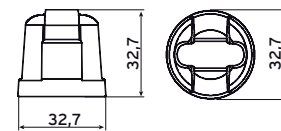

Cubetto / Cube / Glaçons / Cubitos  
18 gr

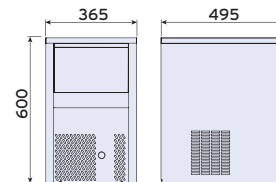

CIM 20/5

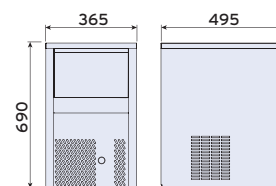

CIM 30/10

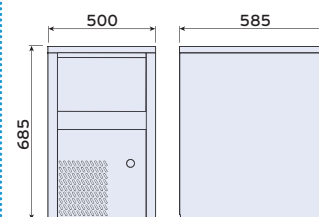

CIM 45/15



- Costruzione in acciaio inox e materiali idonei al contatto con gli alimenti
- **Vasca raccolta ghiaccio integrata**
- Gas R404a
- Condensazione (A) aria o (W) acqua
- Controlli elettronici
- Voltaggi speciali, su richiesta
- Macchine rispondenti alle normative di igiene e di sicurezza in vigore
- **Condizioni di lavoro standard:**  
temperatura acqua 15°C  
temperatura ambiente 20°C



- *Construction in stainless steel and specific materials approved for contact with food stuff*
- **Self contained ice collecting bin**
- Gas R404a
- (A) Air or W (Water) condensing
- Electronic controls
- Special voltages, on request
- Machines comply with hygiene and safety regulations
- **Standard working conditions:**  
incoming water temperature 15°C  
environment air temperature 20°C



- Construction en acier inox et matériaux pour aliments
- **Bac à glace incorporée**
- Gaz R404a
- Condensation (A) air ou (W) eau control électronique
- Tensions spéciales, sur demande
- Machines conformes aux normes en vigueur en matière d'hygiène et de sécurité
- **Conditions de travail standard:**  
temperature eau 15°C  
temperature environnement 20°C



- Estructura de acero inoxidable y materiales para alimentos
- **Cuba recolección hielo incorporada**
- Gas R404a
- Comandos electrónicos condensación (A) aire o (W) agua
- Voltajes especiales a petición
- Máquinas conformes a las normas vigentes en materia de higiene y seguridad
- **Condiciones de trabajo standards:**  
temperatura entrada agua: 15°C  
temperatura ambiente: 20°C

|   | CIM 20/5  | CIM 30/10  | CIM 45/15  |
|---|---|--|--|
| Produzione - Productivity<br>Production - Producción                              | 20 kg/24 h<br>1176 cubetti/cubes/glaçon/cubitos | 30 kg/24 h<br>1764 cubetti/cubes/glaçon/cubitos  | 45 kg/24 h<br>2647 cubetti/cubes/glaçon/cubitos  |
| Capacità deposito - Storage capacity<br>Capacite bac - Capacidad depósito         | 5 kg<br>294 cubetti/cubes/glaçon/cubitos approx | 10 kg<br>588 cubetti/cubes/glaçon/cubitos approx | 15 kg<br>882 cubetti/cubes/glaçon/cubitos approx |
| Potenza elettrica - Electrical Power<br>Puissance électrique - Potencia eléctrica | 0,35 kW   | 0,45 kW  | 0,65 kW  |
| Peso netto - Net weight - Poids net - Peso neto                                   | 33 kg   | 36 kg  | 52 kg  |

ACCESSORI - ACCESSORIES - ACCESSOIRES - ACCESORIOS (pag. 27-30)

