

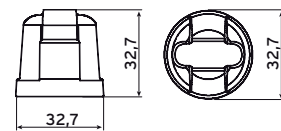

50-80-100 kg/24 h

 Cubetto / Cube / Glaçons / Cubitos  
18 gr

CIM 50/25

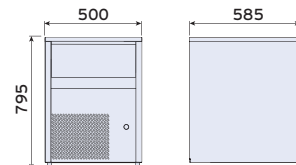
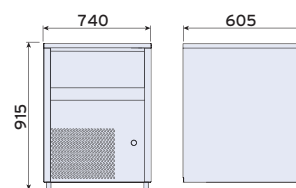

CIM 80/40

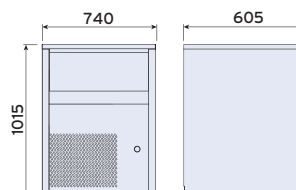

CIM 100/60



- Costruzione in acciaio inox e materiali idonei al contatto con gli alimenti
- **Vasca raccolta ghiaccio integrata**
- Gas R404a
- Condensazione (A) aria o (W) acqua
- Controlli elettronici
- Voltaggi speciali, su richiesta
- Macchine rispondenti alle normative di igiene e di sicurezza in vigore
- **Condizioni di lavoro standard:**  
temperatura acqua 15°C  
temperatura ambiente 20°C



- *Construction in stainless steel and specific materials approved for contact with food stuff*
- **Self contained ice collecting bin**
- *Gas R404a*
- *(A) Air or W (Water) condensing*
- *Electronic controls*
- *Special voltages, on request*
- *Machines comply with hygiene and safety regulations*
- **Standard working conditions:**  
*incoming water temperature 15°C*  
*environment air temperature 20°C*



- Construction en acier inox et matériaux pour aliments
- **Bac à glace incorporée**
- Gaz R404a
- Condensation (A) air ou (W) eau control électronique
- Tensions spéciales, sur demande
- Machines conformes aux normes en vigueur en matière d'hygiène et de sécurité
- **Conditions de travail standard:**  
temperature eau 15°C  
temperature environnement 20°C



- *Estructura de acero inoxidable y materiales para alimentos*
- **Cuba recolección hielo incorporada**
- *Gas R404a*
- *Comandos electronicos condensacion (A) aire o (W) agua*
- *Voltajes especiales a petición*
- *Máquinas conformes a las normas vigentes en materia de higiene y seguridad*
- **Condiciones de trabajo standards:**  
*temperatura entrada agua: 15°C*  
*temperatura ambiente: 20°C*

|   | CIM 50/25   | CIM 80/40   | CIM 100/60  |
|---|---|---|---|
| Produzione - <i>Productivity</i><br>Production - <i>Producción</i>                              | 50 kg/24 h<br>2941 cubetti/cubes/glaçon/cubitos   | 80 kg/24 h<br>4705 cubetti/cubes/glaçon/cubitos   | 100 kg/24 h<br>5882 cubetti/cubes/glaçon/cubitos  |
| Capacità deposito - <i>Storage capacity</i><br>Capacite bac - <i>Capacidad depósito</i>         | 25 kg<br>1470 cubetti/cubes/glaçon/cubitos approx | 40 kg<br>2352 cubetti/cubes/glaçon/cubitos approx | 60 kg<br>3529 cubetti/cubes/glaçon/cubitos approx |
| Potenza elettrica - <i>Electrical Power</i><br>Puissance électrique - <i>Potencia eléctrica</i> | 0,8 kW  | 0,9 kW  | 1,0 kW  |
| Peso netto - <i>Net weight</i> - Poids net - <i>Peso neto</i>                                   | 55 kg   | 72 kg   | 87 kg   |

ACCESSORI - ACCESSORIES - ACCESSOIRES - ACCESORIOS (pag. 27-30)

